

EN ORIGINAL INSTRUCTIONS

IMPORTANT - These instructions are for your safety.
Please read through them thoroughly prior to handling the product and retain them for future reference.

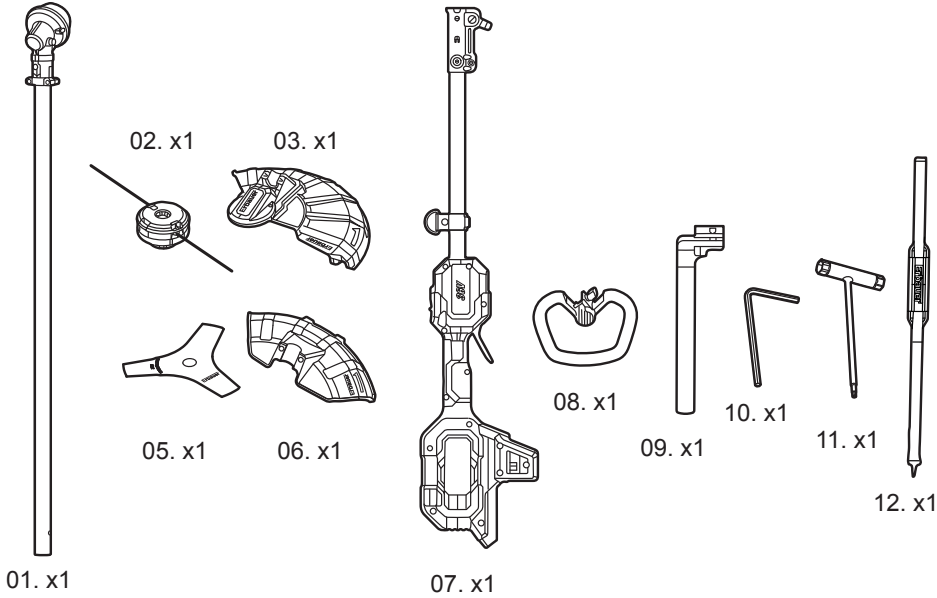

EN Parts



EN You will need

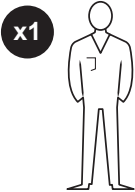

EN Contents

EN	
Product description	4
Safety	5
Technical specification	22
Before you start	23
Functions & Settings	30
Operation	31
Care and maintenance	36
Guarantee	40
Declaration of conformity	42

EN Product Description

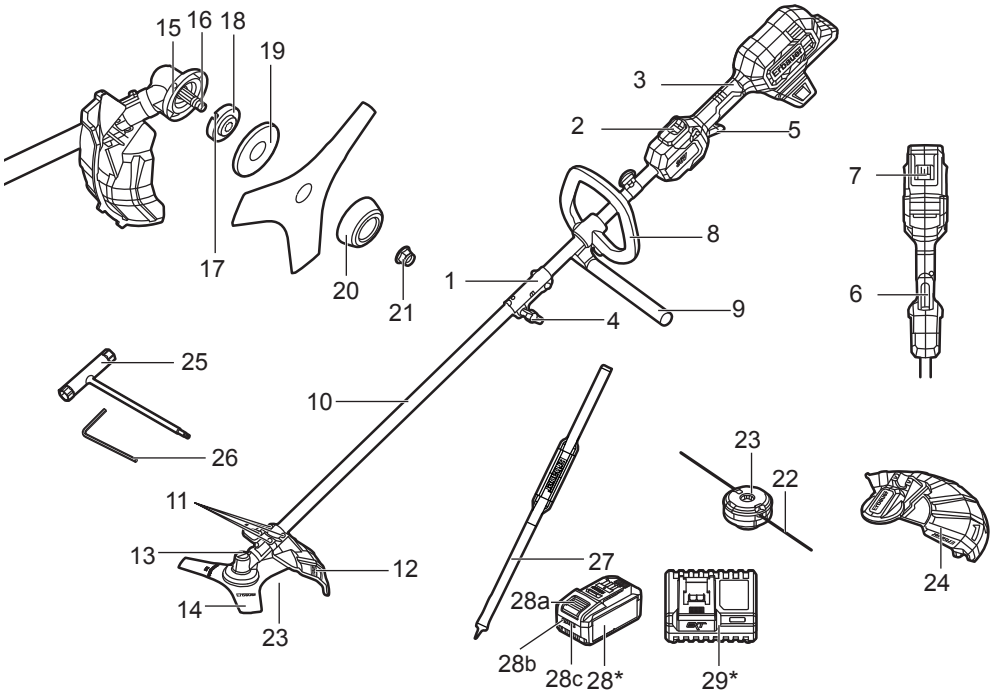

- | | | | |
|-----|--------------------------|------|------------------------|
| 1. | Coupler | 16. | Motor shaft |
| 2. | Speed Mode Switch | 17. | Slot on backing flange |
| 3. | Rear Handle | 18. | Backing flange |
| 4. | Wing Knob | 19. | Flange Cover |
| 5. | Lock-off Button | 20. | Locking flange |
| 6. | Variable Speed Trigger | 21. | Nut |
| 7. | battery docking port | 22. | Trimmer line |
| 8. | Front-Assist Handle | 23. | Trimmer head |
| 9. | Barrier | 24. | Trimmer guard |
| 10. | Lower shaft | 25. | Multi-Function wrench |
| 11. | Screws for guard | 26. | Hex wrench |
| 12. | Blade guard | 27. | Shoulder strap |
| 13. | Gear head | 28* | Battery pack |
| 14. | Cutting blade | a. | Battery release button |
| 15. | Hole for spindle locking | b. | Power bar button |
| 16. | Motor shaft | c. | Power bar |
| 17. | Slot on backing flange | 29*. | Charger |

NOTE: * This may not be included in the supply scope.



General power machine safety warnings



WARNING! Read all safety warnings, instructions, illustrations and specifications provided with this machine. *Failure to follow all instructions listed below may result in electric shock, fire and/or serious injury.*

Save all warnings and instructions for future reference

The term “machine” in the warnings refers to your mains-operated (corded) machine or battery-operated (cordless) machine.

Work area safety

- a) **Keep work area clean and well lit.** *Cluttered or dark areas invite accidents.*
- b) **Do not operate machines in explosive atmospheres, such as in the presence of flammable liquids, gases or dust.** *Machines create sparks which may ignite the dust or fumes.*
- c) **Keep children and bystanders away while operating a machine.** *Distractions can cause you to lose control.*

Electrical safety

- a) **Machine plugs must match the outlet. Never modify the plug in any way. Do not use any adapter plugs with earthed (grounded) machines.** *Unmodified plugs and matching outlets will reduce risk of electric shock.*

- b) **Avoid body contact with earthed or grounded surfaces such as pipes, radiators, ranges and refrigerators.** *There is an increased risk of electric shock if your body is earthed or grounded.*
- c) **Do not expose machines to rain or wet conditions.** *Water entering a machine will increase the risk of electric shock.*
- d) **Do not abuse the cord. Never use the cord for carrying, pulling or unplugging the machine. Keep cord away from heat, oil, sharp edges or moving parts.** *Damaged or entangled cords increase the risk of electric shock.*
- e) **When operating a machine outdoors, use an extension cord suitable for outdoor use.** *Use of a cord suitable for outdoor use reduces the risk of electric shock.*
- f) **If operating a machine in a damp location is unavoidable, use a residual current device (RCD) protected supply.** *Use of an RCD reduces the risk of electric shock.*

Personal safety

- a) **Stay alert, watch what you are doing and use common sense when operating a machine. Do not use a machine while you are tired or under the influence of drugs, alcohol or medication.** *A moment of inattention while operating machines may result in serious personal injury.*

- b) **Use personal protective equipment. Always wear eye protection.** *Protective equipment such as a dust mask, non-skid safety shoes, hard hat, or hearing protection used for appropriate conditions will reduce personal injuries.*
- c) **Prevent unintentional starting. Ensure the switch is in the off-position before connecting to power source and/or battery pack, picking up or carrying the machine.** *Carrying machines with your finger on the switch or energising machines that have the switch on invites accidents.*
- d) **Remove any adjusting key or wrench before turning the machine on.** *A wrench or a key left attached to a rotating part of the machine may result in personal injury.*
- e) **Do not overreach. Keep proper footing and balance at all times.** *This enables better control of the machine in unexpected situations.*
- f) **Dress properly. Do not wear loose clothing or jewellery. Keep your hair and clothing away from moving parts.** *Loose clothes, jewellery or long hair can be caught in moving parts.*
- g) **If devices are provided for the connection of dust extraction and collection facilities, ensure these are connected and properly used.** *Use of dust collection can reduce dust-related hazards.*
- h) **Do not let familiarity gained from frequent use of machines allow you to become complacent and ignore machine safety principles.** *A careless action can cause severe injury within a fraction of a second.*

Machine use and care

- a) **Do not force the machine. Use the correct machine for your application.** *The correct machine will do the job better and safer at the rate for which it was designed.*
- b) **Do not use the machine if the switch does not turn it on and off.** *Any machine that cannot be controlled with the switch is dangerous and must be repaired.*
- c) **Disconnect the plug from the power source and/ or remove the battery pack, if detachable, from the machine before making any adjustments, changing accessories, or storing machines.** *Such preventive safety measures reduce the risk of starting the machine accidentally.*
- d) **Store idle machines out of the reach of children and do not allow persons unfamiliar with the machine or these instructions to operate the machine.** *Machines are dangerous in the hands of untrained users.*
- e) **Maintain machines and accessories. Check for misalignment or binding of moving parts, breakage of parts and any other condition that may affect the machine's operation. If damaged, have the machine repaired before use.** *Many accidents are caused by poorly maintained machines.*
- f) **Keep cutting tools sharp and clean.** *Properly maintained cutting tools with sharp cutting edges are less likely to bind and are easier to control.*

- g) **Use the machine, accessories and tool bits etc., in accordance with these instructions, taking into account the working conditions and the work to be performed.** *Use of the machine for operations different from those intended could result in a hazardous situation.*
- h) **Keep handles and grasping surfaces dry, clean and free from oil and grease.** *Slippery handles and grasping surfaces do not allow for safe handling and control of the machine in unexpected situations.*

Battery machine use and care

- a) **Recharge only with the charger specified by the manufacturer.** *A charger that is suitable for one type of battery pack may create a risk of fire when used with another battery pack.*
- b) **Use machines only with specifically designated battery packs.** *Use of any other battery packs may create a risk of injury and fire.*
- c) **When battery pack is not in use, keep it away from other metal objects, like paper clips, coins, keys, nails, screws, or other small metal objects, that can make a connection from one terminal to another.** *Shorting the battery terminals together may cause burns or a fire.*
- d) **Under abusive conditions, liquid may be ejected from the battery; avoid contact. If contact accidentally occurs, flush with water. If liquid contacts eyes, additionally seek medical help.** *Liquid ejected from the battery may cause irritation or burns.*

- e) **Do not use a battery pack or machine that is damaged or modified.** *Damaged or modified batteries may exhibit unpredictable behaviour resulting in fire, explosion or risk of injury.*
- f) **Do not expose a battery pack or machine to fire or excessive temperature.** *Exposure to fire or temperature above 130°C may cause explosion.*
- g) **Follow all charging instructions and do not charge the battery pack or machine outside the temperature range specified in the instructions.** *Charging improperly or at temperatures outside the specified range may damage the battery and increase the risk of fire.*

Service

- a) **Have your machine serviced by a qualified repair person using only identical replacement parts.** *This will ensure that the safety of the machine is maintained.*
- b) **Never service damaged battery packs.** *Service of battery packs should only be performed by the manufacturer or authorized service providers.*

LINE TRIMMER AND BRUSH CUTTER SAFETY WARNINGS

- a) **Do not use the machine in bad weather conditions, especially when there is a risk of lightning.** *This decreases the risk of being struck by lightning.*
- b) **Thoroughly inspect the area for wildlife where the machine is to be used.** *Wildlife may be injured by the machine during operation.*

- c) **Thoroughly inspect the area where the machine is to be used and remove all stones, sticks, wires, bones, and other foreign objects.** *Thrown objects can cause personal injury.*
- d) **Before using the machine, always visually inspect to see that the cutter or blade and the cutter or blade assembly are not damaged.** *Damaged parts increase the risk of injury.*
- e) **Follow instructions for changing accessories.** *Improperly tightened blade securing nuts or bolts may either damage the blade or result in it becoming detached.*
- f) **The rated rotational speed of the blade must be at least equal to the maximum rotational speed marked on the machine.** *Blades running faster than their rated rotational speed can break and fly apart.*
- g) **Wear eye, ear, head and hand protection.** *Adequate protective equipment will reduce personal injury by flying debris or accidental contact with the cutting line or blade.*
- h) **While operating the machine, always wear safety footwear. Do not operate the machine when barefoot or wearing open sandals.** *This reduces the chance of injury to the feet from contact with a moving cutter, line or blade.*
- i) **While operating the machine, always wear long trousers.** *Exposed skin increases the likelihood of injury from thrown objects.*
- j) **Keep bystanders away while operating the machine.** *Thrown debris can result in serious personal injury.*

- k) **Always use two hands when operating the machine.** *Holding the machine with both hands will avoid loss of control.*
- l) **Hold the machine by the insulated gripping surfaces only, because the cutting line or blade may contact hidden wiring.** *Cutting line or blades contacting a “live” wire may make exposed metal parts of the machine “live” and could give the operator an electric shock*
- m) **Always keep proper footing and operate the machine only when standing on the ground.** *Slippery or unstable surfaces may cause a loss of balance or control of the machine.*
- n) **Do not operate the machine on excessively steep slopes.** *This reduces the risk of loss of control, slipping and falling which may result in personal injury.*
- o) **When working on slopes, always be sure of your footing, always work across the face of slopes, never up or down and exercise extreme caution when changing direction.** *This reduces the risk of loss of control, slipping and falling which may result in personal injury.*
- p) **Keep all parts of the body away from the cutter, line or blade when the machine is operating. Before you start the machine, make sure the cutter, line or blade is not contacting anything.** *A moment of inattention while operating the machine may result in injury to yourself or others.*

- q) **Do not operate the machine above waist height.** *This helps prevent unintended cutter or blade contact and enables better control of the machine in unexpected situations.*
- r) **When cutting brush or saplings that are under tension, be alert for spring back.** *When the tension in the wood fibers is released, the brush or sapling may strike the operator and/or throw the machine out of control.*
- s) **Use extreme caution when cutting brush and saplings.** *The slender material may catch the blade and be whipped toward you or pull you off balance.*
- t) **Maintain control of the machine and do not touch cutters, lines or blades and other hazardous moving parts while they are still in motion.** *This reduces the risk of injury from moving parts.*
- u) **Carry the machine with the machine switched off and away from your body.** *Proper handling of the machine will reduce the likelihood of accidental contact with a moving cutter, line or blade*
- v) **When transporting or storing the machine, always fit the cover on metal blades.** *Proper handling of the machine will reduce the likelihood of accidental contact with the blade.*
- w) **Only use replacement cutters, lines, cutting heads and blades specified by the manufacturer.** *Incorrect replacement parts may increase the risk of breakage and injury.*

- x) **When clearing jammed material or servicing the machine, make sure the switch is off and the battery pack is removed.** *Unexpected starting of the machine while clearing jammed material or servicing may result in serious personal injury.*

BLADE THRUST CAUSES AND RELATED WARNINGS

Blade thrust is a sudden sideways, forward or backward motion of the machine, which may occur when the blade jams or catches on an object such as a sapling or a tree stump. It can be violent enough to cause the machine and/or operator to be propelled in any direction, and possibly lose control of the machine.

Blade thrust and its related hazards can be avoided by taking proper precautions as given below.

- a) **Maintain a firm grip with both hands on the machine and position your arms to resist blade thrust. Position your body to the left side of the machine.** *Blade thrust can increase the risk of injury due to the machine moving unexpectedly. Blade thrust can be controlled by the operator if proper precautions are taken.*
- b) **If the blade binds, or when interrupting a cut for any reason, switch the machine off and hold the machine motionless in the material until the blade comes to a complete stop. While the blade is binding, never attempt to remove the machine from the material or pull the machine backward while the blade is in motion, otherwise blade thrust may occur.** *Investigate and take corrective actions to eliminate the cause of blade binding.*

- c) **Do not use blunt or damaged blades.** *Blunt or damaged blades increase the risk of jamming or catching on an object, resulting in blade thrust.*
- d) **Always maintain good visibility of the material being cut.** *Blade thrust is more likely to occur in areas where it is difficult to see the material being cut.*
- e) **If you are approached by another person while operating the machine, switch the machine off.** *There is an increased risk of injury to other persons being struck by the moving blade in the event of blade thrust.*

Additional safety warnings for line trimmer and brush cutters:

- a) **Damage to Trimmer** - *If you strike a foreign object with the trimmer or it becomes entangled, stop the machine immediately, check for damage and have any damage repaired before further operation is attempted. Do not operate with a broken guard or spool.*
- b) **If the equipment should start to vibrate abnormally, stop the motor and check immediately for the cause.** *Vibration is generally a warning of trouble. A loose head may vibrate, crack, break or come off the trimmer, which may result in serious or fatal injury. Make sure that the cutting attachment is properly fixed in position. If the head loosens after fixing it in position, replace it immediately. Never use a trimmer with a loose cutting attachment.*
- c) *The cutting accessory guard and handle adjustments should be made with the motor stopped and battery removed.*

- d) *Keep hands away from any sharp device intended to limit the length of the filament line.*
- e) *Once encountered blockage of the cutting accessory or cutting head, stop the motor and removed battery, inspect the cutting accessory or cutting head and clean all the foreign objects which cause blockage. This blockage situation may cause overheating of the motor.*
- f) *National regulation can restrict the use of the machine.*
- g) *Need daily inspection before use and after dropping or other impacts to identify any significant defects.*
- h) *For brush cutters, use slip-resistant foot protection, as well as protective clothing when operating it.*
- i) *Keep firm footing and balance during operation, including the need to use the harness provided.*
- j) *Advice to inspect machine for damage upon striking a hard object or if there appears to be excessive vibration.*
- k) *When wearing a harness, no other wearable interferes with the release and removal of the harness.*

Vibration and noise reduction

To reduce the impact of noise and vibration emission, limit the time of operation, use low-vibration and low- noise operating modes as well as wear personal protective equipment.

Take the following points into account to minimize the vibration and noise exposure risks:

1. Only use the product as intended by its design and these instructions.

2. Ensure that the product is in good condition and well maintained.
3. Use correct application tools for the product and ensure they in good condition.
4. Keep tight grip on the handles/grip surface.
5. Maintain this product in accordance with these instructions and keep it well lubricated (where appropriate).
6. Plan your work schedule to spread any high vibration tool use across a longer period of time.
7. Prolonged use of the product exposes the user to vibrations that can cause a range of conditions collectively known as hand-arm vibration syndrome (HAVS) e.g. fingers going white; as well as specific diseases such as carpal tunnel syndrome. To reduce this risk when using the product, always wear protective gloves and keep your hands warm.

Emergency

Familiarise yourself with the use of this product by means of this instruction manual. Memorise the safety directions and follow them to the letter. This will help to prevent risks and hazards.

- 1. Always be alert when using this product, so that you can recognise and handle risks early.** Fast intervention can prevent serious injury and damage to property.
- 2. Switch off and disconnect from the power supply if there are malfunctions.** Have the product checked by a qualified professional and repaired, if necessary, before you operate it again.

Residual risks

Even if you are operating this product in accordance with all the safety requirements, potential risks of injury and damage remain. The following dangers can arise in connection with the structure and design of this product:

1. Health defects resulting from vibration emission if the product is being used over long periods of time or not adequately managed and properly maintained.
2. Injuries and damage to property due to broken accessories or the sudden impact of hidden objects during use.
3. Danger of injury and property damage caused by flying objects.



WARNING! This product produces an electromagnetic field during operation! This field may under some circumstances interfere with active or passive medical implants! To reduce the risk of serious or fatal injury, we recommend persons with medical implants to consult their doctor and the medical implant manufacturer before operating this product!

SAVE THESE INSTRUCTIONS!

Symbols

On the product, the rating label and within these instructions you will find among others the following symbols and abbreviations. Familiarise yourself with them to reduce hazards like personal injuries and damage to property.

V	Volt, (direct current voltage)	/min or min ⁻¹	Per minute
mAh	Milliampere per hour	mm	Millimetre
m	Metre	kg	Kilogram
l	Litre	m/s ²	Metres per second squared
cm ³	Cubic centimetre	dB(A)	Decibel (A-rated)
yyWxx	Manufacturing date code: year of manufacturing (20yy) and week of manufacturing (Wxx).		



Read the instruction manual.



Caution / Warning.



Wear hearing protection!



Wear eye protection!



Wear protective gloves!



Wear slip-resistant, sturdy footwear!



Wear safety helmet!



Wear face protection!



Wear tight-fitted protective clothes.



Use appropriate protection for foot-leg and hand-arm.



Switch the product off and remove the battery pack to disconnect from the power supply before assembly, cleaning, adjustments, maintenance, storage and transportation.



WARNING –Beware of blade thrust



WARNING –Disconnect battery before maintenance



WARNING – The distance between the machine and bystanders shall be at least 15 m



Keep the pole mounted powered pruner a sufficient distance away from electrical power lines.



Objects thrown by the product could hit the user or other bystanders. Always ensure that other people and pets remain at a safe distance from the product when it is in operation. In general, children must not come near the area where the product is. Minimum distance 15m.



Do not use in rain or wet conditions.



Guaranteed sound power level value in dB(A).



WEEE symbol. Waste electrical products should not be disposed of with household waste. Please recycle where facilities exist. Check with your Local Authority or local store for recycling advice.



Crossed out dust bin. Batteries and battery packs should not be disposed of with household waste. Please recycle where facilities exist. Check with your Local Authority or local store for recycling advice.



Do not dispose of battery packs in rivers or immerse in water.



Do not dispose of battery packs in fire. They will explode and cause injury.



Do not expose battery packs to heat in excess of 40 °C.

Do not charge or store the battery pack in temperatures below 5 °C (41 °F) and above 40 °C (104°F).



The product complies with the applicable Your product European directives and an evaluation method of conformity for these directives was done.



UK Conformity Assessed

Rating label explanation

Cordless Brush Cutter: ERT1026GBC

ER= Brand name(Erbauer)

T=36V Lithium-Ion

1026=Serial number

GBC=Garden brush cutter

EN Technical specifications

General:

- > Rated voltage 36V 
- Extension pole





For Grass trimmer:

- Maximum speed n_0 (two-speed switch): 5000/6000/min
- > Trimming line Non-metallic(nylon),2.0mm
- > Cutting width 38cm
- > Total length of cutting line 5m
- > Weight(without battery pack, cutting head ,cutting attachment cover and harness.) 4.45kg
- > Ambient temperature range for machine and battery use 0°C to 40°C



For Brush Cutter:

- > Rated no-load speed n_0 5000/6000/min
- > Brush cutting device Mental cutting blade
- > Blade reference Punch
- > Blade size Ø250 x Ø25.4 x 2mm, 3T
- > Weight(without battery pack, cutting accessory, cutting accessory cover, harness) 4.065kg
- > Ambient temperature range for machine and battery use 0°C to 40°C

Battery pack (may not be included)

- | | | |
|-------------|---|---|
| > Model no. | ERT1044BAT | ERT1045BAT |
| > Type | Li-Ion | Li-Ion |
| > Voltage | 18V  / 36V  | 18V  / 36V  |
| > Capacity | 8 Ah / 4Ah | 6 Ah / 3 Ah |
| > Weight | approx. 1.2 kg | approx. 1.2 kg |

Charger for battery pack (may not be included)

- | | | |
|---|---|---|
| > Model no. | ERT1047CHR | ERT1046CHR |
| > Rated input | 220-240 V~ 50/60 Hz | 220-240 V~ 50/60 Hz |
| > Rated output | 21 V  12 A | 21 V  x2 12 A x2 |
| > Ambient temperature range for battery and charger to use. | 5°C to 40°C | 5°C to 40°C |

Sound values:

- > Sound pressure level L_{pA} 81dB
- > Uncertainty K_{pA} 3dB
- > Guaranteed sound power level L_{WA} XX

> Measured sound power level L_{WA}	91dB
> Uncertainty K_{WA}	1.1dB
> Front handle vibration value a_h	4.23m/s
> Rear handle vibration value a_h	4.74m/s

Sound values (For brush cutter):

> Sound pressure level L_{pA}	82dB
> Uncertainty K_{pA}	3dB
> Guaranteed sound power level L_{WA}	XX
> Measured sound power level L_{WA}	93dB
> Uncertainty K_{WA}	1.6dB
> Front handle vibration value a_h	2.44m/s
> Rear handle vibration value a_h	1.53m/s

The sound value(s) have been determined according to noise test code given in EN IEC 62841-1 and EN ISO 11806-1, using the basic standards EN ISO 22868 and EN ISO 11201. The sound intensity level for the operator may exceed 80 dB(A) and ear protection measures are necessary.

The declared total vibration value(s) and the declared noise emission value(s) have been measured in accordance with a standard test method and may be used for comparing one tool with another;

The declared total vibration value(s) and the declared noise emission value(s) may also be used in a preliminary assessment of exposure.



WARNING! The vibration and noise emission during actual use of the power tool can differ from the declared total value depending on the ways in which the tool is used especially what kind of work piece is processed; The need to identify safety measures to protect the operator that are based on an estimation of exposure in the actual conditions of use (taking account of all parts of the operating cycle such as the times when the tool is switched off and when it is running idle in addition to the trigger time).



EN Before you start

Unpacking

1. Unpack all parts and lay them on a flat, stable surface.
2. Remove all packing materials and shipping devices if applicable.
3. Make sure the delivery contents are complete and free of any damage. If you find that parts are missing or show damage do not use the product but contact your dealer. Using an incomplete or damaged product represents a hazard to people and property.
4. Ensure that you have all the accessories and tools needed for assembly and operation. This also includes suitable personal protective equipment.



WARNING! The product and the packaging are not children's toys! Children must not play with plastic bags, sheets and small parts! There is a danger of choking and suffocation!

You will need

(items not supplied)

Suitable personal protective equipment

(items supplied)

Shoulder strap



NOTE: The accessories required depend on the intended application. Ask your dealer for advice.

EN Assembly



WARNING! The product must be fully assembled before operation! Do not use a product that is only partly assembled or assembled with damaged parts!



WARNING! Disconnect the battery pack from the machine before making any assembly, adjustments, changing accessories, or storing machine. Such preventive safety measures reduce the risk of starting the machine accidentally.



Follow the assembly instructions step-by-step and use the pictures provided as a visual guide to easily assemble the product!

Before using the product, familiarise yourself with the operating features read the entire instruction manual paying particular attention to the safety rules and operating procedures.

Do not connect the product to battery pack before it is completely assembled!

Power head:

Installing/Removing a Power Head Attachment



WARNING! Never install, remove, or adjust any attachment while the power head is running or with the battery installed. Failure to stop the motor and remove the battery can cause serious personal injury.



WARNING! NEVER OPERATE THE POWER HEAD WITHOUT AN ATTACHMENT.

Installing a power head attachment (Fig. 2a & 2b)

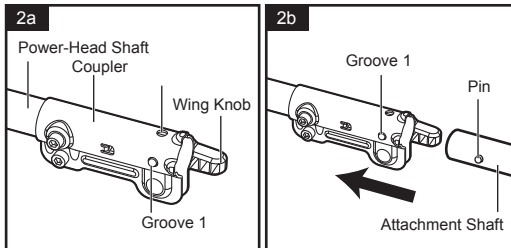

a. Remove the battery pack.

- b. Loosen the wing knob.
- c. The power head has two grooves on the coupler, ONLY the groove 1 is used to connect an attachment.
- d. Align the spring-loaded pin on the attachment shaft with the groove 1 on the coupler and push the attachment shaft into the power head shaft until the pin pops out of the groove and you hear an audible “click” sound at the same time.
- e. Pull the attachment shaft to verify that it is securely locked into the coupler.
- f. Tighten the wing knob securely.

Removing the attachment from the power head (Fig. 2c)

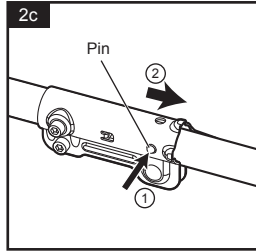

- a. Remove the battery pack.
- b. Loosen the wing knob.
- c. Press down the spring-loaded pin and pull the attachment shaft out of the coupler.

Refer to Installing/Removing a Power Head Attachment for extension pole Installing/Removing

Mounting and Adjusting the Front-Assist Handle (Fig. 3a & 3b & 3c)

- a. Remove the battery pack from the power head.
- b. Loosen the wing nut and remove it along with the hex bolt from the front-assist handle.
- c. Press the front-assist handle onto the shaft and reinstall the hex bolt and the wing nut. Turn the front-assist handle upward so that it points toward the top of the rear handle.
- d. Adjust the front-assist handle position so that it is within the mounting zone, as shown in Fig. 3c. The handle should be positioned so that the arm that is holding the handle is straight when using the power head.

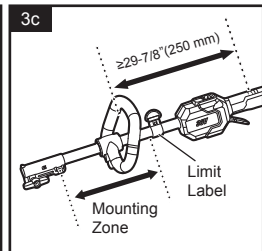
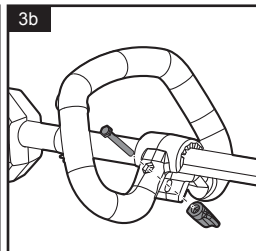
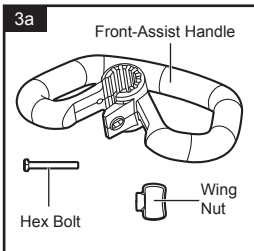



WARNING! The front-assist handle should be positioned within the mounting zone, not exceeding the limit label, so that the distance between the center of the handles is at least 250 mm for safe operation.

- f. Tighten the wing nut to prevent the handle from rotating around the shaft.

Shoulder strap

The shoulder strap (27) helps the operator carry this product.

- a. Place the shoulder strap (27) over your left shoulder so that it runs over the left shoulder, crossing the chest and back. (Fig. 4).

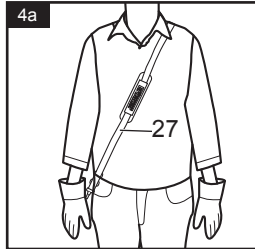

- b. Fasten the snap hook on the securing clip on the shaft (Fig. 5).
- c. The length of the shoulder strap can be adjusted.

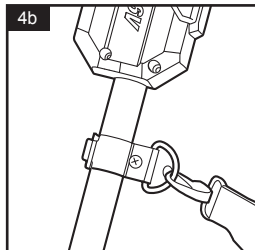

- d. The harness can be buckled or released with shoulder strap loop by the quick-release mechanism.



WARNING! Always attach the product to the shoulder strap. Do not carry it only with your hands!

MOUNTING THE GUARD (FIG. 5a&5b)

Blade guard

Align the blade guard mounting holes with the assembly holes on the lower shaft (10) and then lock it with the two screws (Fig. 5a) using hex key tool (26).

Trimmer guard

Use the same method to attach the trimmer guard (24) as above. Then attach the cover on the trimmer guard (24) with other two screws (Fig. 5b).

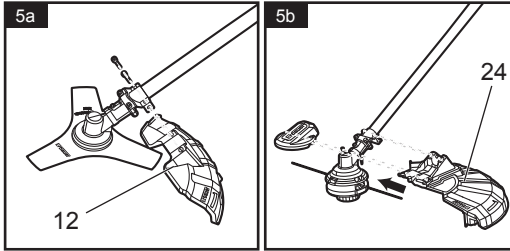

WARNING! Never use the product without properly fitted guard!



WARNING! For all work with the machine, a correct protection guard (for brush cutting or for grass trimming application) must always be mounted carefully.

BRUSH CUTTING BLADE (FIG. 6a-6b):

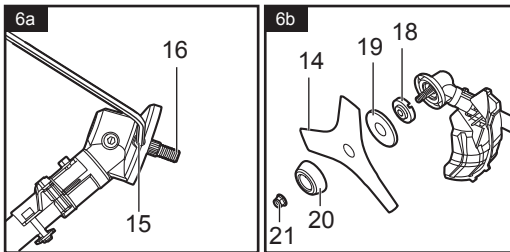

1. Make sure that the blade guard (12) has been attached properly.
2. Rotate the spindle until the hole on backing flange (17) is aligned with the hole of spindle locking in the gear head (13).
3. Insert the hex wrench (26) into the hole to lock the spindle (Fig. 6a).
4. Loosen the nut (21) clockwise and remove it together with the locking flange (20) using multi function wrench (25).
5. Fit the cutting blade (14) onto the spindle ensuring that the directional arrows on the blade guard (12) and the cutting blade (14) match. Ensure that the blade sits flush on the extruded ring on the backing flange (18).

6. Place the locking flange (20) onto the cutting blade (14).
7. Secure the cutting blade (14) with the nut (21) by using the multi-function wrench (25) (Fig. 6b).
8. Remove the hex wrench (26).



NOTE: Take off the blade cover before using and save it for storage.

TRIMMING HEAD (FIG. 7a-7b)

Make sure that the trimmer guard (24) has been attached properly.

Rotate the spindle until the hole on backing flange (17) is aligned with the hole of spindle locking in the gear head (13).

Insert the hex wrench (26) into the hole to lock the spindle (Fig. 7a).

Loosen the nut (21) clockwise and remove it together with the locking flange (20) using multi function wrench (25).

Fit the trimmer head (23) onto the spindle and rotate it anti-clockwise to assembly it (Fig. 7b).

Remove the hex wrench (26).

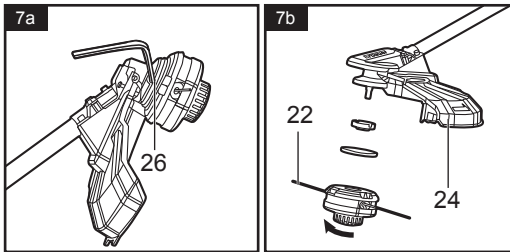

Installing the Barrier(Fig.8a-8c)



WARNING!

- Install the guard before the attachment is connected to the power head.
- To reduce the risk of injury to persons, do not operate without guards in place. The guard must always be on the tool to protect the user.

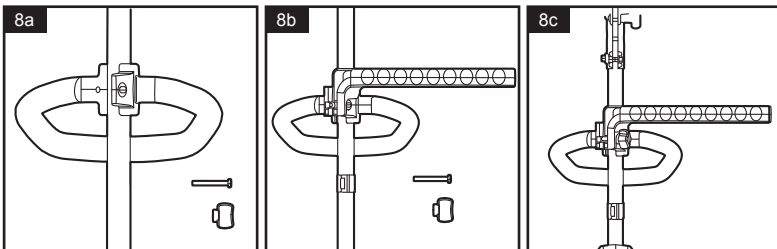

1. Lift the power head and turn upside down on a flat surface and loose the wing nut.
2. Align the slot of the barrier (9) with the front assist handle (8), and then tighten the wing nut so that it cannot move during operation

Battery pack

Attaching / releasing the battery pack(Fig.9)

1. Slide the battery pack into the battery docking port (7) until it is securely locked in position.
2. Depress the battery pack release button to release and slide the battery pack out from your tool. (Fig. 9)

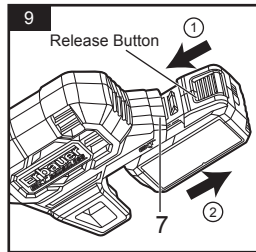

3. After recharge, slide the battery pack back into your tool. A simple push and slight pressure will be sufficient.





Charging the battery pack

The battery pack for this product has been shipped in a low charge condition. Charge it fully before first use.

Refer to the charger's instruction manual for the details.

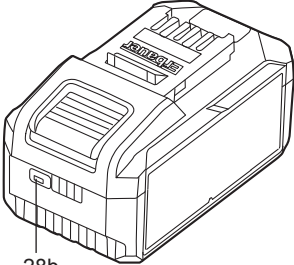
Battery pack power bar(Fig.10)

The Li-Ion battery pack is equipped with a power bar which is used to give an indication of the battery pack's remaining charge. Press the power bar button to check battery charge as below. The LED will stay lit for approximately 5 seconds.

 <p>28b</p> <p>■ On □ Off</p>	76-100% Charge	
	51-75% Charge	
	26-50% Charge	
	5-25% Charge	

EN Functions & settings

Intended use

You may use the brush cutter for the purpose listed below:

With the blade attached, the product is intended to cut heavier weeds, brush and similar vegetation with a thickness of up to 20mm.

With the trimming head attached the product is intended to cut smaller types of weed, lawn grass or similar soft vegetation in areas that are hard to reach, e.g. under bushes, on slopes and edges. It may not be used to work on unusual thick, dry or wet grass, e.g. pasture grass, or to shred leaves.

Power head Switching on/off(Fig.11)



WARNING! Never operate the power head without an attachment. Do not attempt to start the power head without an attachment.

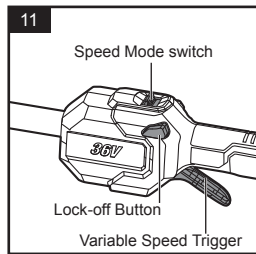

To start the power head

1. To turn the power head ON, push the lock-off button to the left or right and then depress the variable-speed trigger.
2. The variable-speed trigger delivers higher speed with increased trigger pressure and lower speed with decreased trigger pressure.
3. Push the speed mode switch forward is speed 2, and pull it back is speed 1.

To stop the power head

Release the variable-speed trigger to stop the power head.



WARNING! Always remove the battery pack during work breaks and after finishing work.

The brush cutter blade will stop running completely after release the switch trigger and lock-off lever about 10s. Never put the product on the ground and/or touch the blade when it is still running.

EN Operation

USING THE MACHINE



WARNING! Never operate the tool without the guard and handle (8)(9) firmly in place. Failure to comply could result in possible serious personal injury.



WARNING! To prevent accidental starting that could cause serious personal injury, always remove the battery pack from the tool when assembling parts or transporting the machine.



WARNING! If any parts are damaged or missing, do not operate the brush cutter until the parts are replaced. Use of the brush cutter with damaged or missing parts could result in serious personal injury.



WARNING! Always wear heavy gloves when installing or removing the guard and doing any maintenance on the blade trimmer head. Be careful of the line-cutting blade on the guard.

USING WITH TRIMMER HEAD(Fig.12a-b):

Hold the product firmly with both handles. Make sure the product will contact with protector during working. (Fig. 12a)

Stand upright, do not lean forward and pay attention to posture. Keep both feet apart to help retain your balance.

Hold the trimming head just above the ground. Avoid pressing it against the ground as this can ruin the lawn and damage the product.

Move the product with a slow regular arc from left to right before moving it back to the starting position and trimming the next area (Fig. 12a).

Ensure the cutting device remains clean and free from off-cuts that may cause it to jam.

Check regularly. Release the on/off switch (6) and remove the battery pack before checking.

Trim longer grass in stages; do not cut long grass in one cut. For the best results, cut longer grass in steps (Fig. 12b).

Wait until the product has come to a standstill before placing it down.

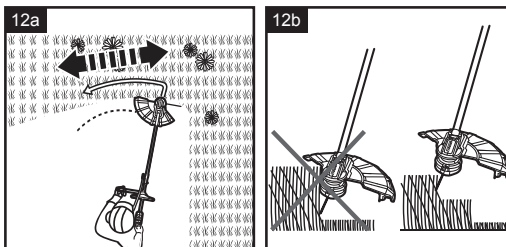



NOTE: For best results, do not cut wet grass because it tends to stick to the trimming head and guard, prevents proper discharge of grass trimmings, and could cause you to slip and fall.



NOTE: Pay special attention when performing the work close to trees and bushes. The trimming head could damage sensitive bark, and damage fence posts.



NOTE: Carefully manoeuvre the product around objects, such as trees and bushes, ensuring it does not come into contact with them.

TRIMMING LINE FEEDING (Fig.13)

During use, the tip of the trimming line gets shorter due to wear. Regularly check the condition of the trimming line and adjust if necessary. The trimming head is equipped with a bumper helping to release the trimming line while operating.



NOTE:The line feeding system works only when the product is switched on.



NOTE:Line release will become more difficult if the cutting line becomes too short.

1. Tap the bumper on solid ground and the spool releases trimming line.
2. Excess line is by the knife and should always remain inside the radius of the guard.

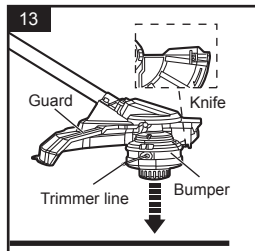

WARNING!Do not remove or alter the line-cutting blade assembly. Excessive line length will cause the motor to overheat and may result in serious personal injury.

USING BLADE:



WARNING!To cut wild growth and scrub, lower the rotating blade down onto the growth to achieve a chopping effect. Use the brush cutter like a scythe (sweep it to the right and left) at ground level. Do not use the cutting unit above waist height.



WARNING! The higher the cutting unit is off the ground, the greater the risk of injury from cuttings being thrown sideways.



WARNING! When cutting young trees or other woody materials up to 2cm in diameter, use the left side of the blade to avoid blade thrust situations. Do not attempt to cut woody material with a larger diameter, since the blade may catch or jerk the brush cutter forward. This may cause damage to the blade or the brush cutter or loss of control of the brush cutter, resulting personal injury.



WARNING! Improper use of a blade may cause it to crack, chip, or shatter. Thrown parts may seriously injure the operator or bystander. To reduce the risk of personal injury, it is essential to take the following precautions:

- Avoid contact with hard or solid foreign objects such as stones, rocks or pieces of metal.
- Never cut wood or shrubs with a stem diameter of more than 2cm.
- Inspect the blade at a regular short interval for signs of damage. Do not continue working with a damaged blade.
- Re-sharpen the blade regularly (when it has dulled noticeably) and have it balanced if necessary (performed by a qualified service technician). With particular emphasis on the effects of blade thrust behaviour that may result if specifications are not followed.

Blade thrust

Exercise extreme caution when using the blade with this unit. Blade thrust is the reaction that may occur when the spinning blade contacts anything it cannot cut. This contact may cause the blade to stop for an instant and suddenly “thrust” the unit away from the object that was hit. This reaction can be violent enough to cause the operator to lose control of the unit. Blade thrust can occur without warning if the blade snags, stalls, or binds. This is more likely to occur in areas where it is difficult to see the material being cut. For cutting ease and safety, approach the weeds being cut with the brush cutter from the right to the left. In the event an unexpected object or woody stock is encountered, this practice could minimise the blade thrust reaction.

Cutting (Fig. 14):

Hold the product handle firmly. Make sure the product will contact with protector during working.

Stand upright, do not lean forward and pay attention to posture. Keep both feet apart to help retain your balance (Fig. 14).

Never hold the cutting head higher than your hip; the higher you hold the cutting head will increase the risk of objects being thrown.

When cutting grass or thin stands use the brush cutter like a scythe (sweep it left to right) at ground level (Fig. 14).

When cutting wild overgrowth or scrub carefully lower the blade from above (Fig. 14).

Exercise extreme caution when using this method. The higher the cutting head is off the ground, the greater the risk of injury.

Follow the correct working posture as shown in the picture (Fig.14), Need rest and changing working positions regularly.



OVERLOAD, TEMPERATURE AND CHARGING PROBLEM

Problem	TOOL / BATTERY STATUS	Possible cause	Solution
Overload protection	Product suddenly stops	Extremely high torque, binding and stalling situations, overloading of the tool	Relieve the load immediately, reset the tool by switching off and back on again.
Temperature extremely high	The first and the third LED light of the POWER BAR will be flashing alternately	Battery temperature exceeds 77°C during operation	Cool down the battery to below 77°C for operation and below 57°C for charging.
Low charge	Power for the tool will drop quickly; The first LED on the POWER BAR begins to flash	The battery pack is under 5% charge	Remove the battery pack from the tool and charge it
Other problems	Short charges	Not fully charged	Make sure that battery is fully charged every time by allowing the charger to complete its full charging cycle
		Poor storage condition	Always remove battery from the tool and charger when not in use and store in a dry secure place. Avoid charging or storing your battery in temperatures below 5°C and above 40°C. Cool down a hot battery pack from a tool that has just been operated for approximately 30 minutes before storage

EN Care and maintenance



WARNING! Always switch the product off, remove the battery pack and let the product cool down before performing inspection, maintenance and cleaning work!

Only perform care and maintenance work according to these instructions! All further works must be performed by a qualified specialist! Improper maintenance can cause serious injuries.

BLADE REPLACEMENT



WARNING! Wear safety gloves when working on the cutting device and close to it!

Use appropriate tools to remove debris e.g. a brush or wooden stick! Never use your bare hands!

Always use original spare parts for replacement. Do not attach any other type of cutting device! Using other cutting attachments can cause serious injuries.

Keep the cutting blade (14) clean and free of debris. Remove trimmings.

Replace the cutting blade (14) with a one of the same type when it is worn or shows damage.

Refit the blade to the spindle as described in section “ASSEMBLING THE MACHINE – BLADE”.

TRIMMING LINE REPLACEMENT



NOTE: The thread on the spindle is left-hand. Turn clockwise to remove and turn anticlockwise to secure the trimmer head.

1. Turn the product upside down to access the trimmer head (23).
2. Rotate the spindle until the hole on backing flange (17) is aligned with the hole of spindle locking in the gear head (13).
3. Insert the hex wrench (26) into the hole to lock the spindle (Fig. 7a).
4. Loosen the trimmer head clockwise and remove it from the spindle.
5. Turn the bumper (23b) clockwise until the arrow (23c) on the bumper (23b) aligns with the arrow on the trimmer head (23) exactly (Fig. 15, step 1). Turn the bumper (23b) anticlockwise slightly if necessary.
6. Insert the trimming line into the “line in” hole of the trimmer head until it appears at opposite hole (Fig. 15, step 2). Maintain the same length of trimming line on each side (e.g. for a 4 m long trimming line, ensure there are 2 m on each side).

7. Turn the bumper (23b) clockwise to wind the trimming line in (Fig. 15, step 3) until around 175 mm of trimming line remains on each side.
8. Tighten the trimmer head anti-clockwise on the spindle and remove the locking pin afterwards.

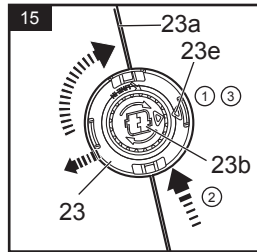

GUARD

Keep the trimming guard (24) and blade guard (12) clean and free of debris. Remove trimmings.

Replace the trimming guard (24) and blade guard (12) with one of the same type when it is worn or shows damage.

CLEAN

- Clean the product with a dry cloth. Use a brush for areas that are hard to reach.
- In particular clean the switches and air vents after every use with a cloth and brush.
- Remove stubborn dirt with high pressure air (max. 3 bar).
- Check for worn or damaged parts. Replace worn parts as necessary or contact an authorised service centre for repair before using the product again.



NOTE: Do not use chemical, alkaline, abrasive or other aggressive detergents or disinfectants to clean this product as they might be harmful to its surfaces.

MAINTENANCE

Your power tool requires no additional lubrication or maintenance.

There are no user serviceable parts in your power tool.

Before and after each use, check the product and accessories (or attachments) for wear and damage. If required, exchange them for new ones as described in this instruction manual.

Observe the technical requirements.

Cleaning and maintenance before storage.

Spare parts / Replacement parts

The following parts of this product may be replaced by the consumer. Spare parts are available at an authorised dealer or through our customer service.

Description	Model no. or Specification
Trimmer head	Non-metallic(nylon),2.0mm
Brush cutter blade	Ø250 x Ø25.4 x 2mm, 3Teeth

Repair

This product does not contain any parts that can be repaired by the consumer. Contact an authorized service centre or a similarly qualified person to have it checked and repaired.

Storage

1. Clean the product as described above.
2. Store the product and its accessories in a dry, frost-free, well- ventilated place.
3. Always store the product in a place that is inaccessible to children. The ideal storage temperature is between 10 and 30°C.
4. We recommend using the original package for storage to protect it against dust.



WARNING! Always charge the battery pack before storage! Please charge the battery pack to 3 bars on the battery light indicator. If the tool will not be used for long periods of time, charge the battery pack every 3-6 months. It is important to disconnect the charger from the power supply after charging has finished. Cool down battery pack from a just-operated product for approximately 20 minutes before attempting to recharge!

Transportation

1. Switch the product off and remove the battery pack.
2. Attach transportation guards, if applicable.
3. Always carry the product on its handles.
4. Protect the product from any heavy impact or strong vibrations which may occur during transportation in vehicles.
5. Secure the product to prevent it from slipping or falling over.
6. Use a transport cover for metal blades during transport and storage.

Recycling and disposal



Waste electrical products should not be disposed of with household waste. Please recycle where facilities exist. Check with your Local Authority or local store for recycling advice.

For further information visit www.recycle-more.co.uk.

The product comes in a package that protects it against damage during shipping. Keep the package until you are sure that all parts have been delivered and the product is working properly. Recycle the package afterwards.

Disposal of an exhausted battery pack



The battery is Li-Ion type. To preserve natural resources, please recycle or dispose of the battery pack properly. Consult your local waste authority for information regarding available recycling and / or disposal options.

Discharge your battery pack by operating your tool, then remove the battery pack from the tool and cover the battery pack connections with heavy duty adhesive tape to prevent short circuit and energy discharge.

Do not attempt to open or remove any of the components.

EN Guarantee

At **Erbauer** we take special care to select high quality materials and use manufacturing techniques that allow us to create ranges of products incorporating design and durability.

We carry out stringent testing procedures on all our tools and are confident that they can provide regular, sustained daily use during the period covered.

This power tool is guaranteed for 3 years from the date of purchase, if bought in store, delivered or bought online. You may only make a claim under this guarantee upon presentation of your sales receipt or purchase invoice. Please keep your proof of purchase in a safe place.

This guarantee covers product failures and malfunctions provided the **Erbauer** power tool was used for the purpose for which it is intended and subject to installation, cleaning, care and maintenance in accordance with standard practice and with the information contained above and in the user manual. This guarantee does not cover defects and damage caused by or resulting from:

- Normal wear and tear
- Overload, misuse or neglect
- Repairs attempted by anyone other than an authorized agent
- Cosmetic damage
- Damage caused by foreign objects, substances or accidents
- Accidental damage or modification
- Failure to follow manufacturer's guidelines
- Loss of use of the goods

This guarantee is limited to parts recognised as defective. It does not, in any case, cover ancillary costs (movement, labour) and direct and indirect damage. If the **Erbauer** power tool is defective during the guarantee period, then we reserve the right, at our discretion, to replace the item with a product of equivalent quality and functionality or to provide a refund.

This guarantee only applies to the country of purchase or delivery and is not transferrable to any other countries. This guarantee is non-transferrable to any other person or product. Relevant local law will apply to this guarantee.

Guarantee related queries should be addressed to a store affiliated with the distributor from where you purchased the **Erbauer** power tool.

Erbauer battery and charger are guaranteed for 2 years and covered by all others terms within the above guarantee.

This guarantee is in addition to and does not affect your statutory rights relating to faulty goods as a consumer.

Manufacturer:

Kingfisher International Products Limited
1 Paddington Square, London, W2 1GG, United Kingdom www.kingfisher.com/products

Distributor:

B&Q plc
Chandlers Ford, Hants, SO53 3LE, United Kingdom
www.diy.com

Screwfix Direct Limited
Trade House, Mead Avenue, Yeovil, BA22 8RT, United Kingdom
www.screwfix.com

**IMPORTANT - RETAIN THIS
INFORMATION FOR FUTURE
REFERENCE: READ CAREFULLY**

EN Customer care and technical helpline

A better way to repair your tools

Kingfisher takes special care in creating high-quality garden power tools that are designed to last. But if a fault develops with your garden power tool and you need to claim under the guarantee, the Customer Care and Technical Helpline can support with technical assistance or if required, arrange a free courier collection from your home, assess your garden power tool for fault, repair it, and return it.

Deciding to repair your product rather than buying a replacement and adding to the mountain of waste is a more sustainable choice and you will be doing your bit for the environment.

How does it work?



NOTE: Before collection, all fuel must be removed from petrol powered machines.

Get in touch

If you need help or more information, please contact the Customer Care and Technical Helpline:

UK 0330 678 3077

ROI 1 800 365 800

Opening hours are Monday – Friday, 8am-5pm

Availability of spare parts

Contact the customer service helpline for assistance or visit www.kingfishersparses.com

For assistance contact the customer services helpline:

UK 0800 0789647 uk@kingfisherservice.com

EIRE 1800 932226 eire@kingfisherservice.com

Further information about this product can also be found at:

www.kingfisher.com/products



EN Declaration of conformity



(EN) EU DECLARATION OF CONFORMITY
(FR) DÉCLARATION UE DE CONFORMITÉ
(PL) DEKLARACJA ZGODNOŚCI UE
(RO) DECLARAȚIA DE CONFORMITATE UE
(ES) DECLARACIÓN UE DE CONFORMIDAD
(PT) DECLARAÇÃO DE CONFORMIDADE UE

Product/ Produit/ Produkt/Produsul/Producto/Produto

- CORDLESS BRUSHCUTTER/ DÉBROUSSAILLEUSE SANS FIL/ BEZPRZEWODOWA PODKASZARKA/ COSITOARE PENTRU TUFÎȘURI FĂRĂ FIR/ DESBROZADORA INALĂMBRICA/ ROÇADORA SEM FIOS
- 85018.1/ ERT1026GBC
- Serial number 00001-99999

Name and address of the manufacturer or his authorised representative:

Nom et adresse du fabricant ou de son mandataire:

Nazwa i adres producenta lub jego upoważnionego przedstawiciela:

Denumirea și adresa producătorului sau a reprezentantului său autorizat:

Nombre y dirección del fabricante o de su representante autorizado:

Nome e endereço do fabricante ou do respetivo mandatário:

Kingfisher International Products B.V.,
Rapenburgerstraat 175E,
1011 VM Amsterdam,
The Netherlands

This declaration of conformity is issued under the sole responsibility of the manufacturer.

La présente déclaration de conformité est établie sous la seule responsabilité du fabricant.

Niniejsza deklaracja zgodności wydana zostaje na wyłączną odpowiedzialność producenta.

Prezenta declarație de conformitate este emisă pe răspunderea exclusivă a producătorului.

La presente declaración de conformidad se expide bajo la exclusiva responsabilidad del fabricante.

A presente declaração de conformidade é emitida sob a exclusiva responsabilidade do fabricante.

Object of the declaration/Objet de la declaration/Przedmiot deklaracji/Obiectul declarației/Objeto de la declaración/Objeto da declaração

Product/Produit/Produkt/Produsul/Producto/
Produto

CORDLESS BRUSHCUTTER/
DÉBROUSSAILLEUSE SANS FIL/
BEZPRZEWODOWA PODKASZARKA/
COSITOARE PENTRU TUFÎȘURI FĂRĂ FIR/
DESBROZADORA INALĂMBRICA/ ROÇADORA
SEM FIOS

Model/Modèle/Model/Modelul/Modelo/ Modelo

85018.1/ ERT1026GBC

The object of the declaration described above is in conformity with the relevant Union harmonisation legislation:

L'objet de la déclaration décrit ci-dessus est conforme à la législation d'harmonisation de l'Union applicable:

Wymieniony powyżej przedmiot niniejszej deklaracji jest zgodny z odnośnymi wymaganiami unijnego prawodawstwa harmonizacyjnego:

Obiectul declarației descris mai sus este în conformitate cu legislația relevantă de armonizare a Uniunii:

El objeto de la declaración descrita anteriormente es conforme con la legislación de armonización

pertinente de la Unión:

O objeto da declaração acima descrito está em conformidade com a legislação de harmonização da União aplicável:

2006/42/EC as amended	Machinery Directive
2014/30/EU as amended	Directive Electromagnetic compatibility
2000/14/EC as amended	Outdoor Noise Directive
2016/1628/EU Regulation	Gaseous and Particulate Pollutant Emission Limits
2011/65/EU as amended	Directive Restriction of the use of certain hazardous substances in electrical and electronic equipment
Directive 2006/42/CE	relative aux machines
2014/30 / UE	telle que modifiée Directive Compatibilité électromagnétique
Directive 2000/14/CE	relative aux émissions sonores extérieures
Règlement (UE) 2016/1628	relatif aux exigences concernant les limites d'émission pour les gaz polluants et les particules polluantes
Directive 2011/65/UE	relative à la limitation de l'utilisation de certaines substances dangereuses dans les équipements électriques et électroniques
2006/42/WE	w zmienionej dyrektywie maszynowej
2014/30 / UE	ze zmianami Dyrektywa Kompatybilność elektromagnetyczna
2000/14/WE	w zmienionej dyrektywie w sprawie hałasu na zewnątrz
2016/1628/UE	limity emisji zanieczyszczeń gazowych i cząstek stałych
2011/65 / UE	ze zmianami Dyrektywa Ograniczenie stosowania niektórych niebezpiecznych substancji w sprzęcie elektrycznym i elektronicznym
2006/42/CE,	astfel a fost modificată Directiva privind echipamentele
2014/30/UE,	astfel a fost modificată Directiva privind compatibilitatea electromagnetică
2000/14/CE,	astfel a fost modificată Directiva privind zgomotul în aer liber
2016/1628/UE	Regulamentul privind emisiile de poluanți gazeși și de particule poluante
2011/65/UE,	astfel a fost modificată Directiva privind limitarea utilizării anumitor substanțe periculoase în echipamentele electrice și electronice
Directiva sobre maquinaria	modificada 2006/42/CE
2014/30/UE	modificada Directiva Compatibilidad electromagnética
2000/14/CE	modificada Directiva sobre ruido al aire libre
2016/1628/Reglamento	de la UE Límites de emisiones de contaminantes gaseosos y partículas
2011/65/UE	modificada Directiva Restricción del uso de determinadas sustancias peligrosas en equipos eléctricos y electrónicos
2006/42/CE	como directiva de máquinas alteradas
2014/30/UE	como alteração da compatibilidade eletromagnética
2000/14/CE	como directiva de ruido exterior alterada
Límites de emisión	de poluentes gasosos e de poluentes de partículas 2016/1628/REGULAMENTO da UE
2011/65/UE	como restrição diretiva alterada da utilização de certas substâncias perigosas em equipamentos elétricos e eletrônicos

<p>Measured Sound Power Level Le niveau de puissance acoustique mesuré Zmierzony poziom mocy akustycznej Nivel de putere acustică măsurat Nivel de potencia sonora medido Nível de potência sonora medido : XXdB(A)</p>	<p>Guaranteed Sound Power Level Le niveau de puissance acoustique garant Gwarantowany poziom mocy akustycznej Nivel de putere acustică garantat Nivel de potencia sonora garantizado Nível de potência sonora garantido : XX dB(A)</p>
<p>References to the relevant harmonised standards used or references to the other technical specifications in relation to which conformity is declared: Références des normes harmonisées pertinentes appliquées, y compris la date de celles-ci, ou des autres spécifications techniques, y compris la date de celles-ci, par rapport auxquelles la conformité est déclarée: Odwołania do odnośnych norm zharmonizowanych, które zastosowano, wraz z datą normy, lub do innych specyfikacji technicznych, wraz z datą specyfikacji, w odniesieniu do których deklarowana jest zgodność: Trimiteri la standardele armonizate relevante folosite, inclusiv data standardului, sau trimiteri la celelalte specificații tehnice, inclusiv data specificațiilor, în legătură cu care se declară conformitatea: Referencias a las normas armonizadas pertinentes utilizadas, incluidas las fechas de las normas, o referencias a las otras especificaciones técnicas, incluidas las fechas de las especificaciones, respecto a las cuales se declara la conformidad: Referências às normas harmonizadas aplicáveis utilizadas, incluindo a data da norma, ou às outras especificações técnicas, incluindo a data da especificação, em relação às quais é declarada a conformidade:</p>	
<p>EN 62841-1:2015+A11:2022 EN ISO 11806-1:2011 EN IEC 55014-1:2021 EN IEC 55014-2:2021</p>	
<p>Where applicable, the notified body DEKRA Testing and Certification GmbH, Handwerkstraße 15, 70565 Stuttgart, Germany, 0158 performed performed Outdoor Noise Directive and issued the certificate: xxxxx Le cas échéant, l'organisme notifié DEKRA Testing and Certification GmbH, Handwerkstraße 15, 70565 Stuttgart, Germany, 0158 a effectué Outdoor Noise Directive et a établi le certificate: xxxxx W stosownych przypadkach jednostka notyfikowana DEKRA Testing and Certification GmbH, Handwerkstraße 15, 70565 Stuttgart, Germany, 0158 przeprowadziła Outdoor Noise Directive i wydała certyfikat: xxxxx După caz, organismul notificat DEKRA Testing and Certification GmbH, Handwerkstraße 15, 70565 Stuttgart, Germany, 0158 a efectuat Outdoor Noise Directive și a emis certificatul: xxxxx Si procede, el organismo notificado DEKRA Testing and Certification GmbH, Handwerkstraße 15, 70565 Stuttgart, Germany, 0158 ha efectuado Outdoor Noise Directive y expide el certificado: xxxxx Se for esse o caso, o organismo notificado: DEKRA Testing and Certification GmbH, Handwerkstraße 15, 70565 Stuttgart, Germany, 0158 efetuou Outdoor Noise Directive e emitiu o certificado: xxxxx</p>	

Authorised signatory and technical file holder/signataire et responsable de la documentation technique
authorisé/ podmiot uprawniony do wystawienia i adres prezechowywania dokumentacji technicznej/
semnatar autorizat și deținător al dosarului tehnic/firmante autorizado y titular del expediente técnico/
signatário autorizado e detentor da ficha técnica

Kingfisher International Products B.V.,
Rapenburgerstraat 175E,
1011 VM Amsterdam,
The Netherlands

A handwritten signature in black ink, appearing to read 'David Awe', with a long horizontal stroke extending to the right.

David Awe
Group Quality Director

30/07/2024



(UK) DECLARATION OF CONFORMITY

Product

- CORDLESS BRUSHCUTTER
- 85018.1/ ERT1026GBC
- Serial number 00001-99999

Name and address of the manufacturer or his authorised representative:

Kingfisher International Products Limited
1 Paddington Square
London
W2 1GG
United Kingdom

This declaration of conformity is issued under the sole responsibility of the manufacturer.

Object of the declaration

Product

Model

CORDLESS BRUSHCUTTER

85018.1/ ERT1026GBC

The object of the declaration described above is in conformity with the relevant legislation:

Supply of Machinery (Safety) Regulations 2008 as amended

Noise Emission in the Environment by Equipment for Use Outdoors Regulations 2001 as amended

The Non-Road Mobile Machinery (Type-Approval and Emission of Gaseous and Particulate Pollutants) Regulations 2018 as amended

Electromagnetic Compatibility Regulations 2016 as amended

The Restriction of the use of Certain Hazardous Substances in Electrical and Electronic Equipment Regulations 2012 as amended

Measured Sound Power Level: XX dB(A)

Guaranteed Sound Power Level: XX dB(A)

Type Approval No: xxxxxx

References to the relevant designated standards used or references to the other technical specifications in relation to which conformity is declared:

EN 62841-1:2015+A11:2022

EN ISO 11806-1:2011

BS EN 62841-1:2015+A11:2022

BS EN ISO 11806-1:2011

EN IEC 55014-1:2021

EN IEC 55014-2:2021

BS EN IEC 55014-1:2021

BS EN IEC 55014-2:2021

Where applicable, the approved body **DEKRA Testing and Certification GmbH, Handwerkstraße 15, 70565 Stuttgart, Germany, 0158** performed Outdoor Noise Directive and issued the certificate: xxxxx

Authorised signatory and technical file holder:

Kingfisher International Products Limited
1 Paddington Square
London
W2 1GG
United Kingdom

A handwritten signature in black ink, appearing to read 'David Awe', with a long horizontal stroke extending to the right.

David Awe
Group Quality Director

On [30/07/2024]

Manufacturer :

UK Manufacturer:

Kingfisher International Products Limited,
1 Paddington Square, London, W2 1GG,
United Kingdom

EU Manufacturer:

Kingfisher International Products B.V.
Rapenburgerstraat 175E
1011 VM Amsterdam
The Netherlands

EN www.diy.com

www.screwfix.com

www.screwfix.ie

**To view instruction manuals online,
visit www.kingfisher.com/products**